

DETAIL A

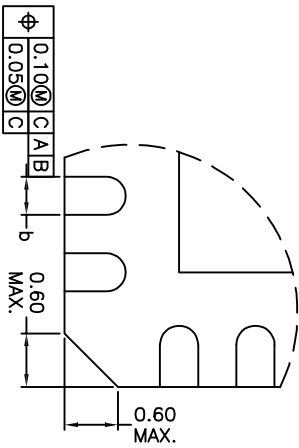
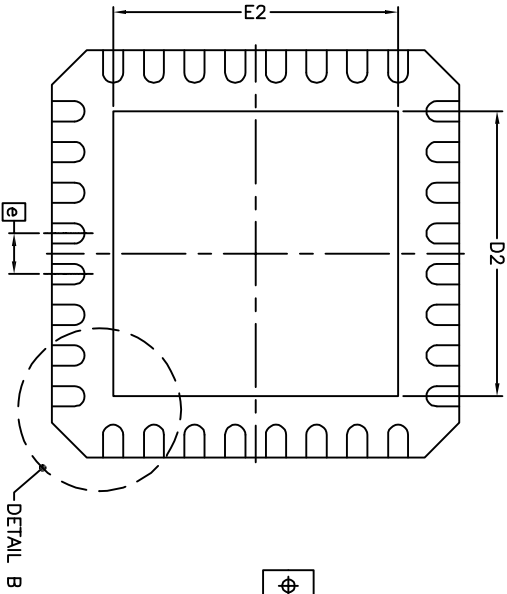
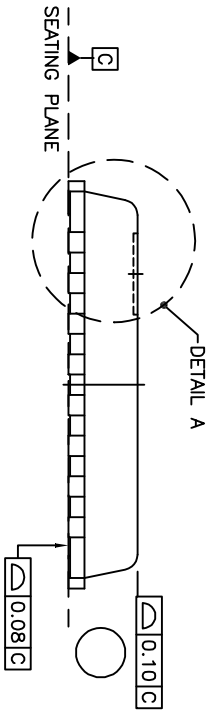

DETAIL B

SYMBOL	DIMENSION (MM)			DIMENSION (MIL)		
	MIN.	NOM.	MAX.	MIN.	NOM.	MAX.
A	0.80	0.85	1.00	31	33	39
A1	0.00	0.02	0.05	0	1	2
A2	-	0.65	1.00	-	26	39
A3	-	0.20	-	-	8	-
b	0.18	0.25	0.30	7	10	12
D	5.00 BSC			197 BSC		
D1	4.75 BSC			187 BSC		
D2	3.20	3.30	3.40	126	130	134
E	5.00 BSC			197 BSC		
E1	4.75 BSC			187 BSC		
E2	3.20	3.30	3.40	126	130	134
e	0.50 BSC			20 BSC		
L	0.30	0.40	0.50	12	16	20
theta	0°	-	14°	0°	-	14°

NOTE :

1. REFER TO JEDEC STD: MO-220.
2. DIMENSION "b" APPLIES TO METALLIZED TERMINAL AND IS MEASURED BETWEEN 0.15MM AND 0.30MM FROM THE TERMINAL TIP. IF THE TERMINAL HAS OPTIONAL RADIUS ON THE OTHER END OF THE TERMINAL, THE DIMENSION B SHOULD NOT BE MEASURED IN THAT RADIUS AREA.



2200 LAURELWOOD RD.
SANTA CARLA, CA 95054
TEL: 408-555-0880
FAX: 408-555-0880

TITLE:

POD for 32LD QFN(5X5), 0.50MM PITCH Chipmoss

DATE:

08/25/08

DOCUMENT NO.

REV. A

SL/POD-00035

Page 1 of 2



Document History Page

Document Title: POD for 32 QFN(5x5), 0.5MM PITCH_ChipMOS

Document Number: SL/POD-00035 Rev. A

Rev.	ECR No.	Date	Orig. of Change	Description of Change
A	ECR-744	8/25/2008	RP	NEW RELEASE